

Check out the Virtual Interactive Workshop to learn more and tell us what you think: <https://SunRailExt.meetsyou.online>

What is the study?

FDOT is studying the feasibility and benefits of extending SunRail into Polk County. The Study examines potential project alternatives, and the benefits, challenges, and costs associated with a potential extension. The study is also looking at how an extension could promote economic development and mobility, as well as potential environmental effects. The process follows federal guidelines, while coordinating closely with the Polk Transportation Planning Organization (TPO), local agencies, municipal partners, and stakeholders.

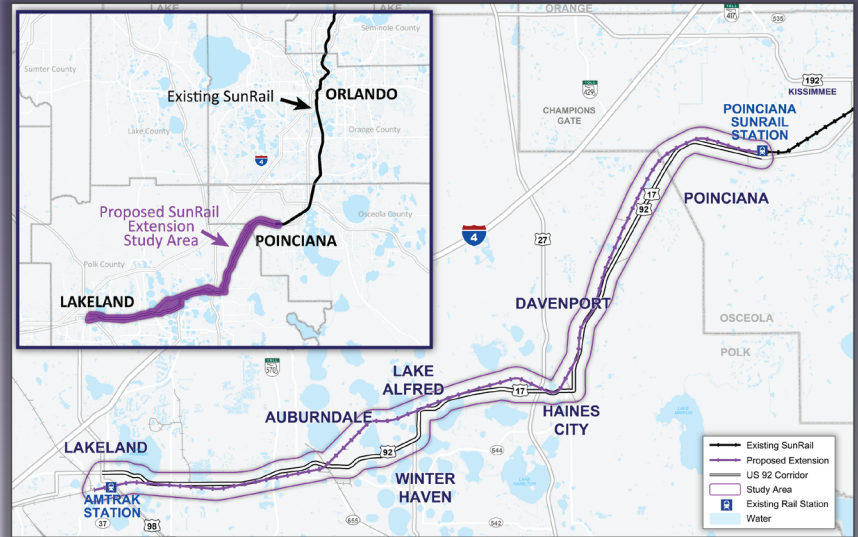

Where would SunRail be extended?

SunRail currently serves Central Florida from DeBary in the north to Poinciana in the south, connecting communities such as Winter Park, Orlando, and Kissimmee. This project would extend service to the west from the Poinciana SunRail station to Lakeland, a distance of approximately 39 miles.

What is the process?

The Study process is a data driven screening of alternatives and uses a variety of data points and analyses to determine how well each alternative serves the goals of the study. Examples of the evaluation include calculating the number of residents and jobs near proposed stations and estimating how many people may ride the train. The process started with seven preliminary alternatives, including one bus alternative, narrowed to four shortlisted alternatives, and will ultimately identify a recommended alternative that could move forward to the next step.



What is the Recommended Alternative?

Each alternative tested different combinations of the station locations. The recommended alternative includes seven potential station locations and scored the best in regard to the study goals. The map shows the preliminary recommendation for extending SunRail service into Polk County, potentially starting service in the year 2035. This represents what the long-term vision for SunRail in Polk County could look like.

7 Stations

- Lakeland
- Polk Parkway
- Auburndale
- Lake Alfred
- Haines City
- Davenport
- Loughman

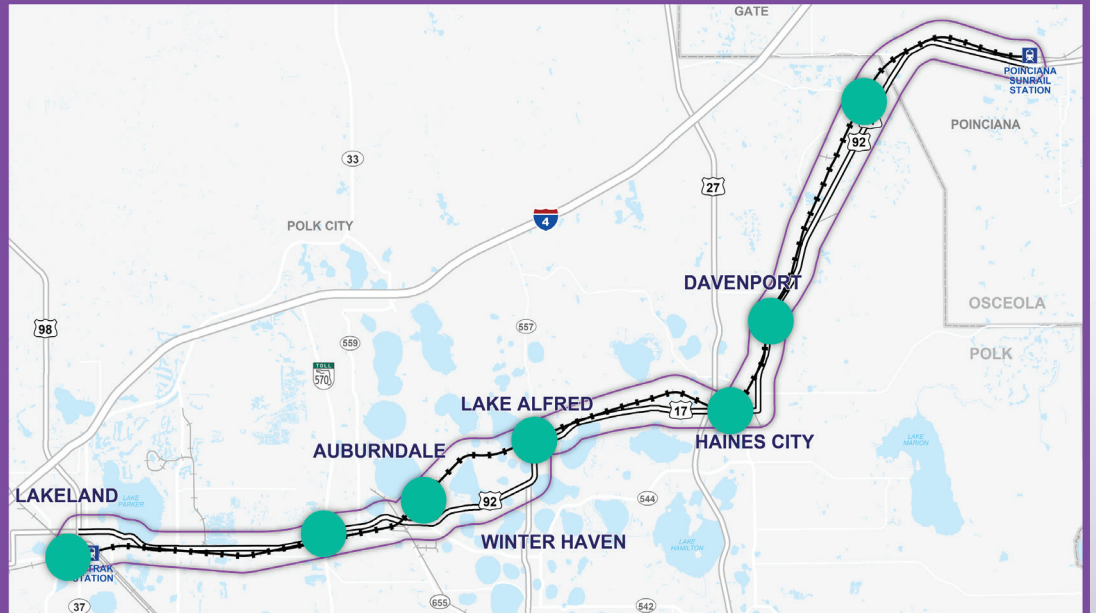

The images below show an artist's rendering of what a station area could look like. Stations will include parking, bicycle and pedestrian access, bus transfer, and a "kiss-and-ride" drop off area.



Small Station

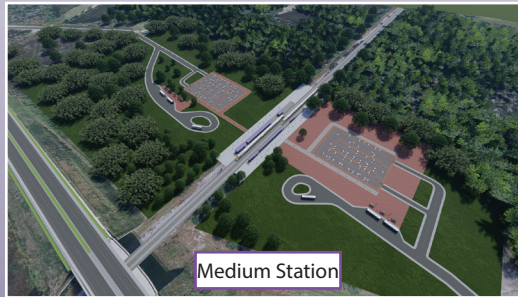

Medium Station



Large Station

How do I get involved?

We invite you to participate in the Virtual Interactive Workshop to learn more about the study and to provide your comments and feedback. Please complete the survey at the end of the virtual public workshop.



For more information, please contact:

Charlene Ross

Modal Project Manager

Florida Department of Transportation

D1.SunRail4Polk@dot.state.fl.us

(863) 519-2390

Public participation is solicited without regard to race, color, national origin, age, sex, religion, disability, or family status. Persons wishing to express their concerns about Title VI may do so by contacting Cynthia Sykes, District One Title VI Coordinator, at (863) 519-2287, or via email at Cynthia.Sykes@dot.state.fl.us.